

Part number

CX 8 J6IM



Male RJ45 connector, IDC, 8 data contacts

Product description

Product type	Data connector
Connection type	RJ45
Gender	Male
Specification	IDC RJ45, Cat. 6A

Technical data

Current	1 A
Voltage	50 V
Rated voltage according to UL/CSA	600V
Wire cross-section	0,41 mm ² - 0,76 mm ²

Further technical details

Insulation resistance	≥ 10 GΩ
Weight	8,60 g
Operating temperature range (min, max)	-40°C...+70°C

Material properties

RoHS conformity	Compliant
China RoHS - EFUP	E
REACH SVHC substances	No

General ordering information

EAN13 code	8015747206211
eCl@ss 8.1	27440205
ETIM 7.0	EC001121

Packaging Information

Packaging length	112,00 mm
Packaging height	95,00 mm
Packaging width	117,00 mm
Packaging weight	0,17 kg
Packaging volume	1,24 dm ³
Packaging description	Carton box
Packaging quantity	10 Pcs
Packaging EAN code	8015747292108
Sub-packaging weight	0,02 kg
Sub-packaging description	Plastic bag
Sub-packaging quantity	1 Pcs
Sub-packaging EAN barcode	8015747206389

Part number

CX 8 J6IM



Catalogue drawings

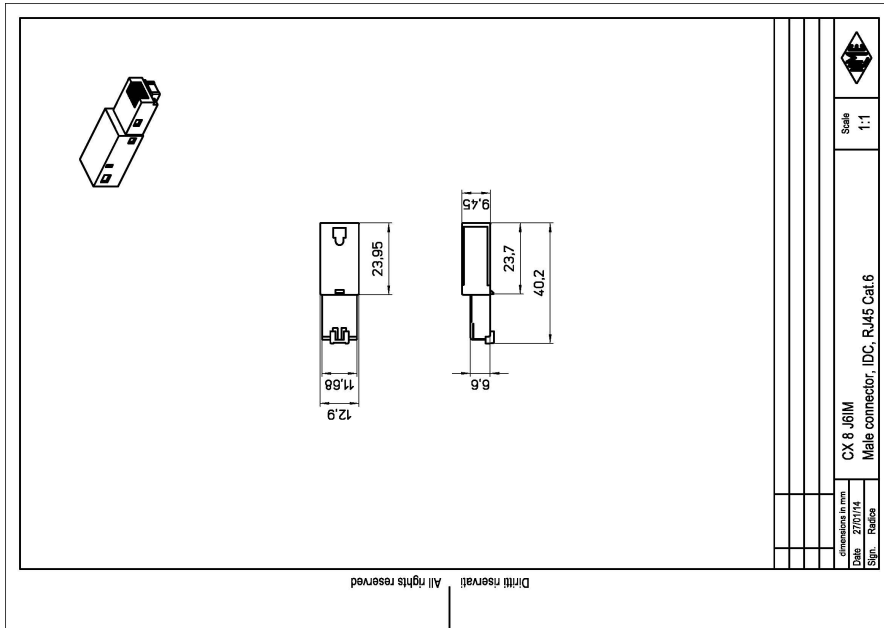

Notes

Dimensions shown in mm are not binding and may be changed without notice.